

B-1202

T handle lock

IP65

RL

S  
SERIES

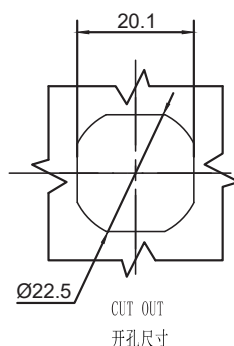
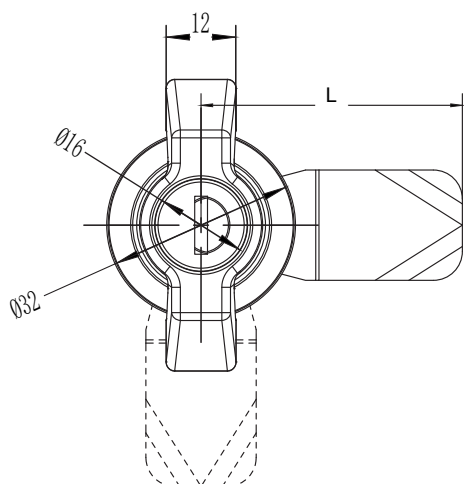
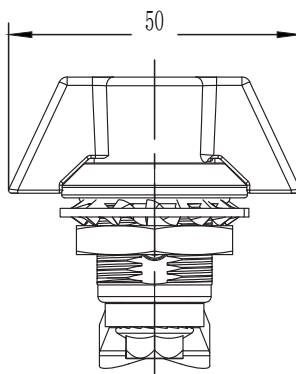
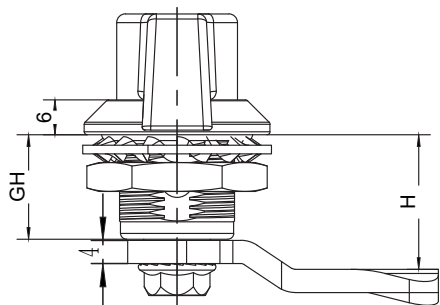

CUT OUT  
开孔尺寸

选型 Model selection

0 代表无锁芯  
0 Non-locking  
1 代表有锁芯  
1 key locking

18 代表锁体 GH 锁体高度, 18/30/40/50/60  
18 represents the height of the lock body GH  
18/30/40/50/60

A1 SUS304  
30 电镀铬  
30 Electrochrome plating  
40 粉末涂层黑  
40 Powder coated black

**B-1202-118-LH-A1**

L 代表钢柱长度  
L represents the length of the steel bolt  
H 代表有效高度  
H represents effective height

1. Material and surface treatment:  
Main body : Zamak DIN-EN 1774-ZnAl4Cu1  
or SUS304  
Steel bolt: iron galvanized or SUS304

2. Performance parameters:  
Protection class: IP65

3. Installation instructions:  
Fixed screw torque 8N. M  
Fixed nut torque 17N. M  
Applicable door panel thickness: 1-8mm

1. 材质及表面处理:  
主体: 5#锌合金 或 SUS304  
钢柱: 铁镀锌 或 SUS304  
密封圈: EPDM发泡胶

2. 性能参数:  
防护等级: IP65

3. 安装说明:  
固定螺丝扭矩 8N.M  
固定螺母扭矩 17N.M  
适用门板厚度: 1-5mm

4. 备注:  
专用钥匙可选  
默认 K333钥匙

如需获得产品 3D 模型图, 请联系 WWW.FORNDLOCK.COM